

## PDC200A

Prime Power: 145KW/181KVA

Standby Power: 160KW/200KVA

Voltage: 400V

Powered by Cummins 6CTA8.3-G1 Engine

### Genset Performance

- 230/400V, 50Hz, 0.8PF, 3 Phases 4 wires
- Frequency drop  $\leq 3\%$
- Voltage regulation  $\leq 0.3\%$
- The steady state frequency  $\leq 0.5\%$
- The steady state voltage deviation  $\leq \pm 1\%$
- The transient frequency deviation  $\leq +10\%$   $\leq -15\%$
- The transient voltage deviation  $\leq +20\%$   $\leq -15\%$
- Frequency recovery time  $\leq 3S$
- Voltage recovery time  $\leq 1S(\text{Voltage} \pm 3\%)$
- THF (Telephone Harmonic Factor)  $< 3$
- TIF (Telephone Influence Factor)  $< 50$
- Comply to Standard NEMA MG1-22.43
- Built-in vibration isolator with high performance on shock absorption.

### Standard Configuration

- Cummins Engine
- Brushless synchronous alternator
- POWERTEC intelligent controller
- 40°C standard ambient temperature (50°C Optional)
- Circuit breaker (3P)
- Float battery charger
- Battery connect wire
- Steel base frame
- Silencer, bellows, exhaust bend
- Manual book and files

### Optional Items

- Starting batteries
- Fuel tank
- Oil-water separator
- Sensor for low coolant level, low fuel/oil level
- Automatically monitoring & controlling system of city power
- Coolant heater
- Oil heater
- Heat exchanger--Water cooled tower system
- Soundproof canopy
- Trailer
- Design and construction of environmental protection engineering for the Genset room



## Diesel Engine

- Model: **6CTA8.3-G1**
- Structure: The cylinder liner adopts a platform mesh honing design and a corrosion-resistant high-nickel cast iron piston, which greatly reduces engine oil consumption, enhanced durability, longer service life
- Integrated design: the cylinder block, cylinder head and other parts are "multi-purpose in one piece", reducing the number of connecting parts; 40% fewer parts than other similar engines, greatly reducing the failure rate;
- Fuel system: Bosch in-line fuel pump, more complete combustion under high injection pressure, less energy loss, More powerful power and strong fuel adaptability;
- Filtration system: Dry core air filter with air intake resistance indicator  
Spin-on Paper Based Full Flow and Bypass Oil Filters Spin-on anti-corrosion water filter;
- Leading design and manufacturing: advanced design, exquisite manufacturing technology, reliable and durable.
- Holset supercharger: with integrated wastegate valve, strong low-speed response and power.

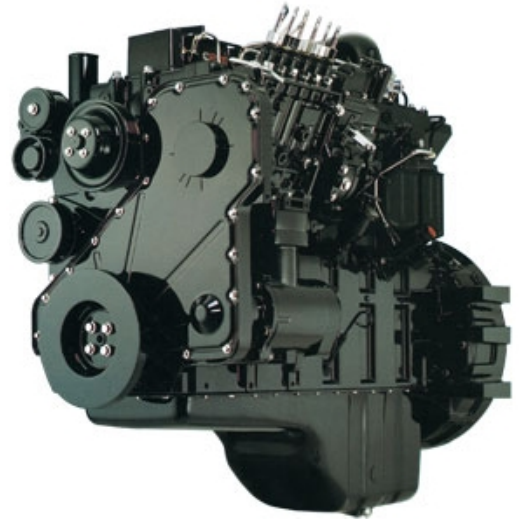

## Alternator

- Optional brands: **Stamford / Marathon / Faraday / Engga / Mecc Alt**
- Brushless, 4 pole rotating magnetic field, single bearing with protective cover.
- Insulation: H Class.
- IP Class: IP23
- Cooling system
- AC exciter, rotate rectifying
- Rotor and exciter made with high temperature insulating resin, to satisfy tough environment.
- Rotor dynamic balancing complys for BS5625, class 2.
- Sealed with advanced lubricating grease to prolong life of bearing.



## Standard

- 3 phases voltage: Ua, Ub, Uc
- Frequency F1
- Apparent power PR
- Power factor PF
- Coolant temperature WT
- Temperature °C display
- Oil pressure OP
- Engine speed
- 3 phases current: La, Lb, Lc
- Active power PA
- Power factor PF
- Temperature °C display
- KPa/Psi/Bar display
- Battery voltage V
- Running Hour
- Starting timer:(999999)



## Standard Protection

### Genset Protection

- Programmable I/O signal
- Emergency stop

### Engine Protection

- Stop for over speed
- Low oil pressure
- High Coolant temperature
- Sensor fail
- Alarm for low/high battery voltage
- Low battery voltage
- Fail to start/Cranking fail

### Alternator Protection

- Over Voltage
- Over current
- Voltage signal lost
- Over Voltage
- Over frequency
- Under frequency

### Control System Components

- Manual/auto/stop/start
- Setting button
- Fault status indicators
- Screen menu selection button
- Emergency stop button
- Digital displayer



## Communication Interface (Option)

- International standard MODBUS communication protocol RS232/ RS485 is suitable for remote control and monitor; It is easy integrated with SCADA;.

## Genset

Model	PDC200A
Prime Rating (kw)	145
Standby Rating (kw)	160
Rate voltage(V)	400
Rate current(A)	262
Power factor	0.8
Frequency(Hz)	50

## Engine

Engine Model	6CTA8.3-G1
Gross Engine output-Prime (kw)	163
Gross Engine output-Standby (kw)	180
Bore * stroke (mm)	114*135
Cylinders and structure	6 In line
Displacement(Liter)	8.3
Compression Ratio	17.3:1
Intake way	Turbocharged/water-Air intercooler
Max intake resistance (KPa)	6.35
Air intake (m3/h)	691
Max exhaust back pressure (KPa)	10
Exhaust gas flow (m3/h)	1876
Exhaust temp (°C)	563
Cooling way	Water Radiator & Fan
Fan exhaust flow (m3/min)	278
Coolant capacity (L)	34
Highest water temperature(°C)	104
Minimum air opening to room (m2)	1.5/1.3
Thermostat range (°C)	82-95
Max oil temperature (°C)	121
Lubrication system oil capacity (L)	27.6
Rate load fuel consumption(L/H)	42
Standard Governor/Class	Mechanical

## Alternator

Rated Voltage(V)	230/400
Output Way	3 Phases, 4 wires
Rated power factor	0.8
Exciter	Brushless, Self-exciter
Max voltage regulation	±1%
Phase	3
Protection class	IP21-23
Insulation class	H

## Controller

Brand	POWERTEC
-------	----------

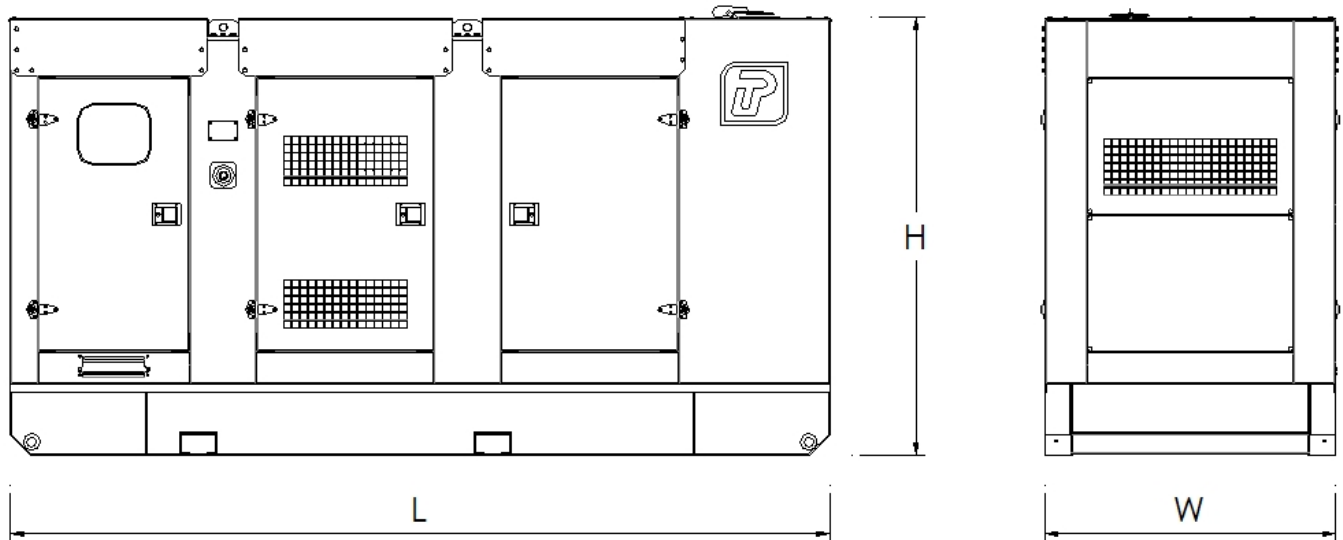
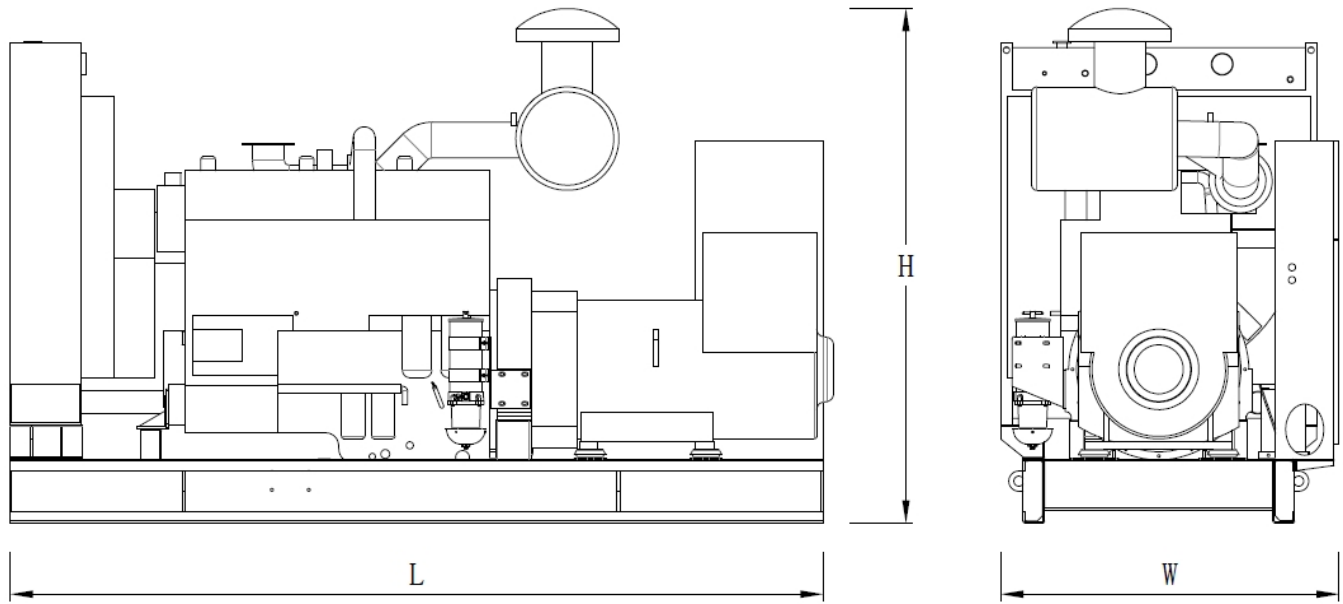

Type	Dimension (mm) (L*W*H)	Weight (kg)	Fuel Tank Capacity (L)
Open Type	2458*960*1592	1800	315
Silent Type	3500*1245*2052	3060	550

## Contact Us

### Powertec Generator System Inc.

**Add:** Danshui Yanna Industry Zone, Huiyang, Huizhou, Guangdong, China  
**Tel:** +86 752-3911119 / 3911118  
**Fax:** +86 752-3911110  
**Web:** [www.powertec.com.cn](http://www.powertec.com.cn)  
**Email:** [powertec@powertec.com.cn](mailto:powertec@powertec.com.cn)